

SET-OUT TABLE	
No.	EASTING NORTHING
1	332854.240 6247255.089
2	332853.799 6247255.116
3	332855.605 6247255.352
4	332857.004 6247255.589
5	332857.249 6247255.521
6	332855.070 6247257.637
7	332854.163 6247255.401
8	332857.621 6247250.085
9	332857.654 6247250.082
10	332857.572 6247246.263
11	332855.729 6247246.371
12	332864.331 6247246.163
13	332864.280 6247246.200
14	332864.765 6247247.095
15	332865.008 6247246.978

**LEGEND**

- CONCRETE FOOTPATH
- ROAD PAVEMENT (MILL AND RE-SHEET)
- EXISTING KERBS AND POLES
- PROPOSED KERBS AND POLES
- PROPOSED PEDESTRIAN RAMP
- PROPOSED GULLY
- EXISTING SMART POLE TO BE RETAINED
- EXISTING TCS
- EXISTING TCS SMARTPOLE TO BE RETAINED
- EXISTING STREET LIGHTING / POST TO BE REMOVED
- PROPOSED TCS SMART POLE
- PROPOSED SMART POLE WITH OUTREACH (NO STREET LIGHT)
- PROPOSED GULLY
- PROPOSED GULLY WITH STREET LIGHT
- PROPOSED GULLY ELECTRICAL FIT
- PROPOSED GULLY MAIN SWITCHBOARD

**NOTES**

- REFER TO DRAWING TCS No. W1340.SA.
- LOCATIONS OF FITS AND POLES IS INDICATIVE AND SUBJECT TO CHANGE DUE TO SITE CONDITION.
- CONSULT WITH UTILITIES PRIOR TO CONSTRUCTION. CONSTRUCTION MUST BE SUBMITTED TO UTILITIES FOR APPROVAL.
- THE INFORMATION PROVIDED IN THIS DESIGN PLAN MUST BE CHECKED ON SITE AND THE MOST CURRENT INFORMATION ON THE CONFIGURATION OF ALL SERVICES MUST BE VERIFIED IMMEDIATELY BEFORE CONSTRUCTION COMMENCES BY CONTACTING DIAL-BEFORE-YOU-DIG BY TELEPHONE ON 1800 GRAY (MWH) 100.COM.AU. INFORMATION MUST BE CURRENT AS INDICATED BY THE UTILITY COMPANIES ON THE DIAL-BEFORE-YOU-DIG INFORMATION AT THE TIME OF CONSTRUCTION.
- ALL EXISTING STREET SIGNS ARE TO BE REINSTATED. REFER TO TCS PLAN FOR TINSW SPECIFIC SIGNAGE.
- WHEN REMOVING EXISTING KERBS AND INSTALLING THE NEW KERB IF THE EXISTING GULLY IS DAMAGED THEN NEW GULLY TO BE INSTALLED. EXISTING GULLY TO BE REINSTATED TO ORIGINAL STANDARD AND PAVEMENT AS PER TINSW STANDARD DRAWING J011 DETAIL J01.
- MILL & RE-SHEET NOMINAL THICKNESS OF 50MM AC14 (A/B/E) (TINSW R116).
- MILL & RE-SHEET TREATMENT IS TO BE UNDERTAKEN TO FULL LANE WIDTH AT ANY AREA WHERE ALTERATION TO LINE MARKING IS CARRIED OUT.
- ALL WORKS WITHIN TINSW JURISDICTION IS TO BE CARRIED OUT IN ACCORDANCE TO RELEVANT TINSW SPECIFICATIONS.

**CLIENT** CITY OF SYDNEY

**PROJECT** LATM UPGRADES COPELAND ST AT MITCHELL RD

**CONSULTANT** AECOM Australia Pty Ltd  
A.B.N 20 093 846 925  
www.aecom.com

**KEY PLAN**

**SCALE BAR** 0 2.5 5 m  
1:100

**PROJECT MANAGEMENT INITIALS**

AL	AK	GS
DESIGNER	CHECKED	APPROVED

**PROJECT DATA**

DATUM	GD494	SURVEY	MGA56
-------	-------	--------	-------

**ISSUE/REVISION**

IR	DATE	DESCRIPTION
02	26.05.2023	FOR APPROVAL
01	05.05.2023	FOR APPROVAL

**PROJECT NUMBER** 60616465  
**SHEET TITLE** GENERAL ARRANGEMENT PLAN  
**SHEET NUMBER** 60616465-002-SHT-6001-CI-0101

This drawing is confidential and shall not be used for the purpose of this project. The signing of this drawing by the design and drafting of this project have been prepared and checked in accordance with the AECOM quality assurance system to BS 9001:2008.

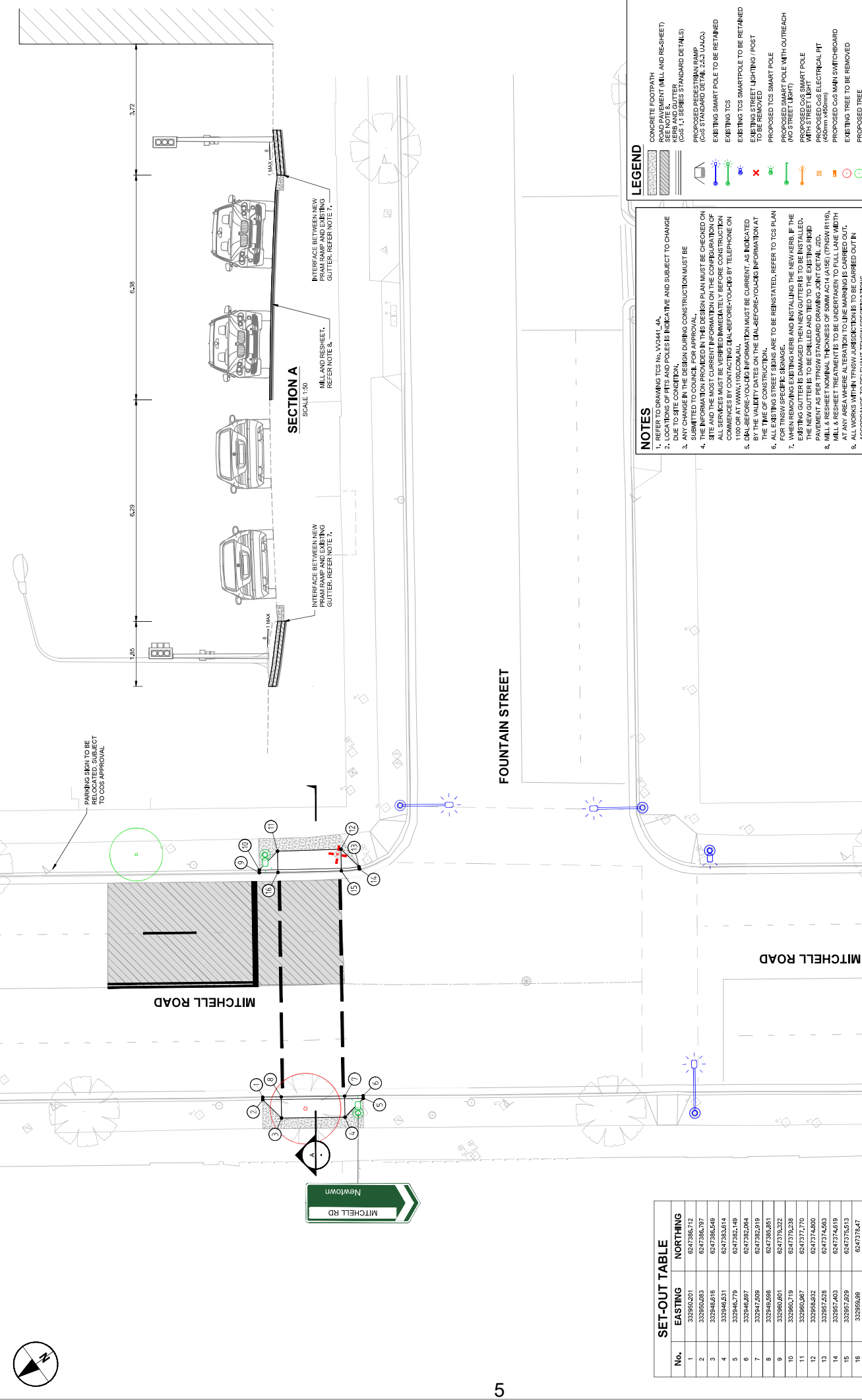

No.	EASTING	NORTHING
1	332950.201	6247386.712
2	332950.033	6247386.797
3	332946.616	6247386.549
4	332946.531	6247383.614
5	332946.779	6247382.148
6	332946.897	6247382.084
7	332947.588	6247382.919
8	332946.956	6247382.851
9	332960.601	6247379.222
10	332960.719	6247379.238
11	332960.967	6247377.770
12	332956.692	6247374.800
13	332957.528	6247374.653
14	332957.403	6247374.619
15	332957.259	6247375.513
16	332959.989	6247375.647

**NOTES**

- REFER TO DRAWING TCS No. V0241\_L/A.
- LOCATIONS OF PITS AND POLES IS INDICATIVE AND SUBJECT TO CHANGE DUE TO SITE CONDITION.
- ALL WORKS TO BE COMPLETED PRIOR TO ANY DRIVING CONSTRUCTION MUST BE SUBMITTED TO TNSV FOR APPROVAL.
- THE INFORMATION PROVIDED IN THIS DESIGN PLAN MUST BE CHECKED ON SITE AND THE MOST CURRENT INFORMATION ON THE CONFIGURATION OF ALL SERVICES MUST BE VERIFIED IMMEDIATELY BEFORE CONSTRUCTION COMMENCES BY CONTACTING DIAL-BEFORE-YOU-DIG BY TELEPHONE ON 100 OR AT WWW.DIBLOCK.COM.AU.
- THE CONSTRUCTION MUST BE CURRENT AS INDICATED BY THE VALUITY DATES ON THE DIAL-BEFORE-YOU-DIG INFORMATION AT THE TIME OF CONSTRUCTION.
- ALL EXISTING STREET SIGNS ARE TO BE REINSTATED, REFER TO TCS PLAN FOR TNSV SPECIFIC SIGNAGE.
- WHEN REMOVING EXISTING KERB AND INSTALLING THE NEW KERB, IF THE EXISTING GUTTER IS DAMAGED THE NEW GUTTER IS TO BE INSTALLED.
- ALL EXISTING GUTTERS ARE TO BE REINSTATED TO ORIGINAL STANDARD PAVEMENT AS PER TNSV STANDARD DRAWING CON DETAIL 02D.
- MILL & RESHET NOMINAL THICKNESS OF 50MM ACH (A3E) (TNSV R116), MILL & RESHET TREATMENTS IS TO BE UNDERTAKEN TO FULL LANE WIDTH AT ANY AREA WHERE ALTERATION TO LINE MARKINGS IS CARRIED OUT.
- ALL WORKS WITHIN TNSV JURISDICTION IS TO BE CARRIED OUT IN ACCORDANCE TO RELEVANT TNSV SPECIFICATIONS.

**LEGEND**

[Symbol]	CONCRETE FOOTPATH
[Symbol]	ROAD PAVEMENT (MILL AND RESHET) SEE NOTE 8.
[Symbol]	PROPOSED PAVEMENT (MILL AND RESHET) (COS L1 SERIES STANDARD DETAILS)
[Symbol]	PROPOSED PAVEMENT RAMP (COS STANDARD DETAIL 5.2.2 (LANO))
[Symbol]	EXISTING SMART POLE TO BE RETAINED
[Symbol]	EXISTING TCS
[Symbol]	EXISTING SMART POLE TO BE RETAINED
[Symbol]	EXISTING STREET LIGHTING / POST TO BE REMOVED
[Symbol]	PROPOSED TCS SMART POLE
[Symbol]	PROPOSED SMART POLE WITH OUTREACH (NO STREET LIGHT)
[Symbol]	PROPOSED SMART POLE
[Symbol]	PROPOSED COS ELECTRICAL PIT (450mm x 450mm)
[Symbol]	PROPOSED COS MAN SWITCHBOARD
[Symbol]	EXISTING TREE TO BE REMOVED
[Symbol]	PROPOSED TREE

This drawing is confidential and shall only be used for the purpose of this project. The signing of this drawing confirms the design and drafting of this project have been prepared and checked in accordance with the AECOM quality assurance system to BS 9001:2008.

**PROJECT**  
 LATM UPGRADES  
 FOUNTAIN ST  
 AT MITCHELL RD

**CLIENT**  
 CITY OF SYDNEY  
 SYDNEY CIVIL

**PROJECT MANAGEMENT INITIALS**

AL	AK	GS
DESIGNER	CHECKED	APPROVED

**ISSUE/REVISION**

02	26.05.2023	FOR APPROVAL
01	05.05.2023	FOR APPROVAL
IR	DATE	DESCRIPTION

**KEY PLAN**  
 SCALE BAR: 0, 2.5, 5 m  
 1:100

**PROJECT NUMBER** 60616465  
**SHEET TITLE** GENERAL ARRANGEMENT PLAN  
**SHEET NUMBER** 60616465-002-SHT-6002-CI-0101